

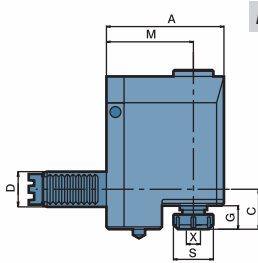

SPUR COUPLING-MT TYPE

MODE: BL
LEFT-HAND

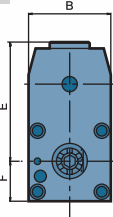

MODE: BR
RIGHT-HAND

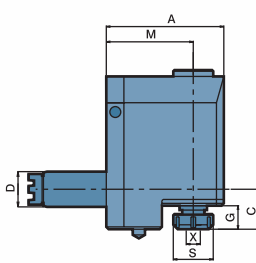
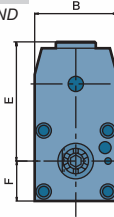

- External coolant supply
- To be used for collet DIN 6499
- Collet is not included

DIMENSIONS

| ORDER NO. | D DIN 69880 | X Capacity | S | Maximum R.P.M. | i | A | B | C | E | F | G | M | CODE NO. |
|--------------------------|----------------|---------------|----|-------------------|-------|-----|----|----|-----|----|----|----|----------|
| BR20MT1657 BL20MT1657 | 20 | 1-10 ER16 | 30 | 5000 | 1 : 1 | 83 | 50 | 35 | 70 | 27 | 27 | 60 | 5006-115 |
| BR30MT2569 BL30MT2569 | 30 | 1-16 ER25 | 42 | 5000 | 1 : 1 | 95 | 60 | 42 | 76 | 32 | 29 | 69 | 5006-116 |
| BR40MT3290 BL40MT3290 | 40 | 2-20 ER32 | 50 | 5000 | 1 : 1 | 124 | 80 | 44 | 110 | 42 | 34 | 90 | 5006-117 |
| BR50MT4090 BL50MT4090 | 50 | 3-26 ER40 | 63 | 5000 | 1 : 1 | 129 | 86 | 49 | 112 | 45 | 39 | 90 | 5006-118 |

Radial Tapping Heads-Backwards

DIMENSIONS

| ORDER NO. | D DIN 69880 | X Capacity | S | Maximum R.P.M. | i | A | B | C | E | F | G | M | CODE NO. |
|----------------------------|----------------|---------------|----|-------------------|-------|-----|----|----|-----|----|----|----|----------|
| TBR30MT1669 TBL30MT1669 | 30 | 1-10 ER16 | 30 | 3000 | 1 : 1 | 95 | 60 | 44 | 76 | 32 | 32 | 69 | 5006-119 |
| TBR40MT2090 TBL40MT2090 | 40 | 1-13 ER20 | 35 | 3000 | 1 : 1 | 124 | 80 | 50 | 110 | 42 | 34 | 90 | 5006-120 |
| TBR50MT2590 TBL50MT2590 | 50 | 1-16 ER25 | 42 | 3000 | 1 : 1 | 129 | 86 | 54 | 112 | 45 | 36 | 90 | 5006-121 |



Radial Drilling And Milling Heads

SET BACK

SPUR COUPLING-MT TYPE

MODE: FL
LEFT-HAND

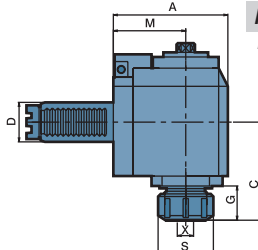
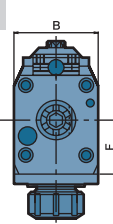

MODE: FR
RIGHT-HAND

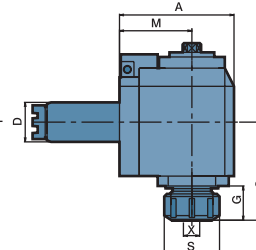
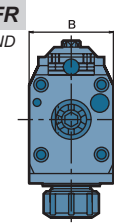

- External coolant supply
- To be used for collet DIN 6499
- Collet is not included

DIMENSIONS

| ORDER NO. | D DIN 69880 | X Capacity | S | Maximum R.P.M. | i | A | B | C | F | G | M | CODE NO. |
|----------------------------|----------------|---------------|----|-------------------|-------|-----|----|------|----|----|-----|----------|
| FR30MT2565 FL30MT2565 | 30 | 1-16 ER25 | 42 | 5000 | 1 : 1 | 97 | 64 | 74.5 | 41 | 26 | 65 | 5006-122 |
| FR30MT2585 FL30MT2585 | 30 | 1-16 ER25 | 42 | 5000 | 1 : 1 | 117 | 64 | 74.5 | 41 | 26 | 85 | 5006-123 |
| FR40MT3265 FL40MT3265 | 40 | 2-20 ER32 | 50 | 5000 | 1 : 1 | 99 | 80 | 71 | 40 | 23 | 65 | 5006-124 |
| FR40MT3285 FL40MT3285 | 40 | 2-20 ER32 | 50 | 5000 | 1 : 1 | 119 | 80 | 71 | 40 | 23 | 85 | 5006-125 |
| FR40MT32100 FL40MT32100 | 40 | 2-20 ER32 | 50 | 5000 | 1 : 1 | 134 | 80 | 71 | 40 | 23 | 100 | 5006-126 |
| FR50MT4075 FL50MT4075 | 50 | 3-26 ER40 | 60 | 5000 | 1 : 1 | 115 | 88 | 103 | 56 | 40 | 75 | 5006-127 |

Radial Tapping Heads

DIMENSIONS

| ORDER NO. | D DIN 69880 | X Capacity | S | Maximum R.P.M. | i | A | B | C | F | G | M | CODE NO. |
|----------------------------|----------------|---------------|----|-------------------|-------|-----|----|-----|----|----|----|----------|
| TFR30MT1665 TFL30MT1665 | 30 | 1-10 ER16 | 30 | 3000 | 1 : 1 | 97 | 64 | 75 | 41 | 30 | 65 | 5006-128 |
| TFR30MT1685 TFL30MT1685 | 30 | 1-10 ER16 | 30 | 3000 | 1 : 1 | 117 | 64 | 75 | 41 | 30 | 85 | 5006-129 |
| TFR40MT2065 TFL40MT2065 | 40 | 1-13 ER20 | 35 | 3000 | 1 : 1 | 99 | 80 | 70 | 40 | 25 | 65 | 5006-130 |
| TFR40MT2085 TFL40MT2085 | 40 | 1-13 ER20 | 35 | 3000 | 1 : 1 | 119 | 80 | 70 | 40 | 25 | 85 | 5006-131 |
| TFR50MT2575 TFL50MT2575 | 50 | 1-16 ER25 | 42 | 3000 | 1 : 1 | 115 | 88 | 103 | 56 | 42 | 75 | 5006-132 |